

Downtown LRT Stations

Connecting Downtown Ottawa

To address the bottleneck of transit service in the downtown the City is moving forward with the Ottawa Light Rail Transit (OLRT) project. To ensure that the downtown core will be effectively served it was determined that 5 of the 13 stations be located within downtown Ottawa, each bringing a unique contribution to Ottawa's transit system and its connections to important downtown destinations.

When choosing where to put the downtown stations and their entrances, the City looked towards two guiding principles:

- Which locations will service the maximum number of riders possible?
- Are those locations technically feasible within our project budget?

Campus Station

The Campus Station is located near the current OC Transpo bus station and will be integrated with the University of Ottawa campus, Colonel By Drive and the historic Rideau Canal. This station will service the Sandy Hill neighbourhood, as well as the Elgin Street business district and the Golden Triangle neighbourhood via the Corktown Footbridge.



Rideau Station

Rideau Station is an underground station located on Rideau Street and will provide access to the historic ByWard Market, the National Gallery, the US Embassy, office buildings, retail shops, and restaurants on Rideau Street and in the Byward Market, as well as destinations such as nearby hotels and the Ottawa Convention Centre. It is also the location of the proposed Arts Hub, bringing together the Ottawa Art Gallery, new theatre space and a number of important local arts organizations.

Downtown East Station

The Downtown East station is an underground station located on Queen Street between Bank and Metcalfe, just two short blocks from the Parliament Hill grounds, including the Peace Tower, House of Commons, the Library of Parliament, Veterans Affairs and Justice Canada.



It will be a similar distance to the National War Memorial and the National Arts Centre.

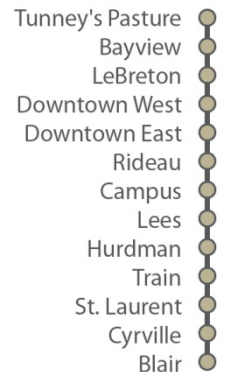

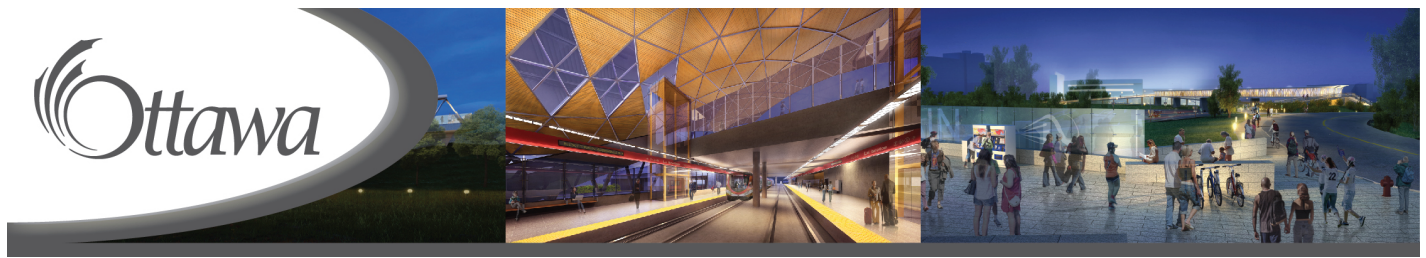

Downtown East station will also serve a number of important corporate addresses, including the World Exchange Plaza, Manulife and Sunlife buildings as well as the Ottawa Public Library, City Hall, Place Bell, the Export Development Corporation and many other prestigious buildings located nearby.

In addition, the City is working closely with the National Arts Centre on the feasibility of connecting the NAC to the downtown East station via a weather-protected pedestrian connection.

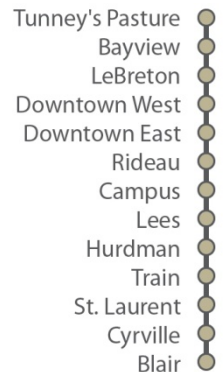

Downtown West Station

Downtown West Station is an underground station located on Queen Street between Lyon and Kent that will provide easy access to a number of significant Ottawa addresses.



These include the Supreme Court of Canada, the National Archives, the National Library, the Justice Building, the Confederation Building, Constitution Square, the Garden of the Provinces, the historic Rideau Club and much more.

It will also provide excellent service to major employment nodes in the area, including both the Place de Ville and Constitution Square complexes.

LeBreton Station

The LeBreton Station, located beneath a reconstructed Booth Street bridge between Albert Street and the aqueduct, will provide direct access to the National War Museum, historic Little Italy neighbourhood, Bronson Avenue, Chinatown, the Good Companions Senior's Centre and the LeBreton Flats community that is currently being constructed.

The LeBreton site has a unique relationship to a number of heritage elements and other neighbourhood amenities, including the Fleet Street Pumping Station, the Ottawa River, Chaudière Falls, the City of Gatineau, nearby recreational trails and the Trans Canada Trail.



Summer festivals that are staged on LeBreton Flats, such as the internationally acclaimed Ottawa Bluesfest, will also benefit from this station location.